

EFFAST

**PRO
FLOW** 



**HIGH PERFORMANCE
BUTTERFLY VALVES**

Welcome to Polypipe

Polypipe is one of Europe's largest manufacturers of piping systems, water management solutions and energy-efficient ventilation systems.

With over 20,000 product lines and more than 3,000 employees, we are fully equipped for projects of all sizes within Residential, Commercial, Industrial and Agricultural sectors – giving us an enviable reputation among installers, contractors, stockists and specifiers.

Located outside Genova, **Polypipe Italia** is the specialist manufacturer of valves and fittings in PVCu, ABS and PPH materials, available via merchants and distributors worldwide.

Our team of technical experts not only provide advice on all types of projects, but it's their experience, skills and knowledge that keeps us at the forefront of innovation.

New H Series Pro Flow High Performance Butterfly Valves

The new H series Pro Flow butterfly valves are ideal for high performance, shut-off or flow regulating applications. Their innovative design allows greater flow rates and reduces pressure drop across the valve.

They are easy to install too, whilst being resistant to corrosion at varying temperatures and chemical stresses. Making them ideal for water treatment solutions, filtration systems, swimming pools and irrigation systems.



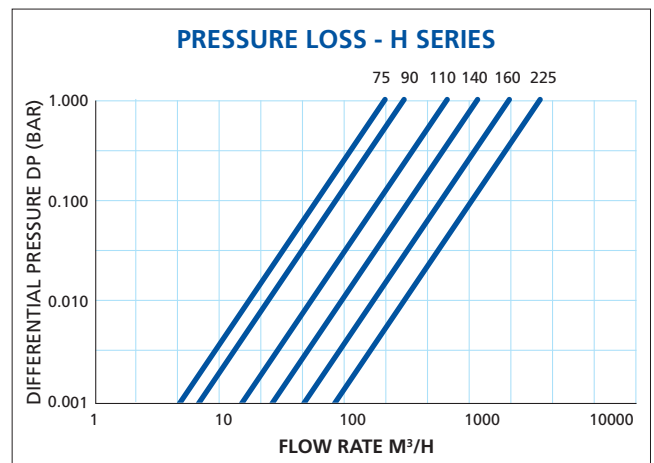
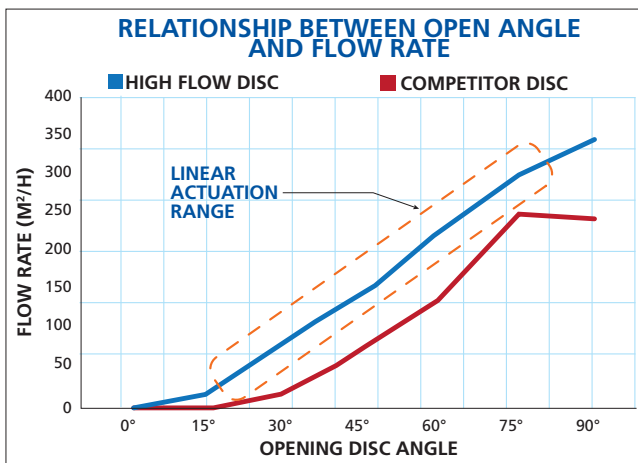
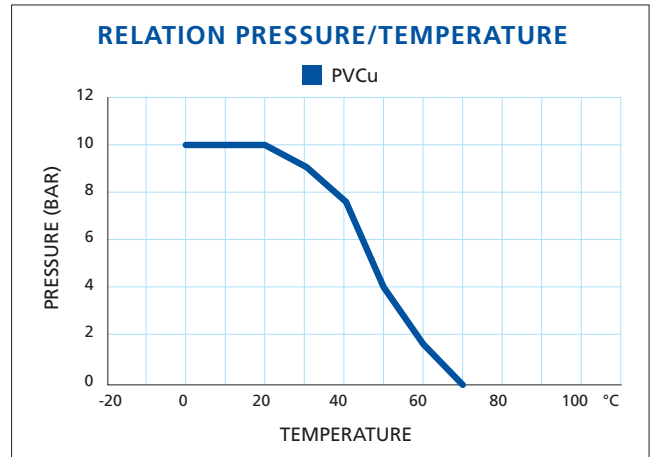
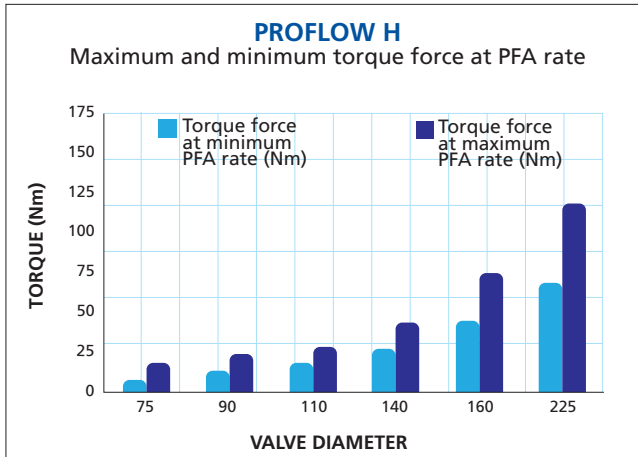

FLOW COEFFICIENT KV 100 (m³/h)

DN	65	80	100	125	150	200
ProFlow H	153	219	456	775	1.368	2.371

Tests performed by certified independent laboratory

EFFAST Quality Marks

Our knowledge and expertise to bring innovation in all we do has helped us produce a specialist range of products and solutions that are always up to date with the very latest regulations and quality standards.





® High Flow Offset Disc

A patented high flow offset disc that has a unique design to allow for a greater flow rate in comparison to traditional discs. The external surfaces are free from sharp edges and ribs, and minimise the low pressure drops.

Special Internal Gasket

Special profile liner with the function of hydraulic seal and isolating all part from the liquid. Anymore usage of additional flat liner.

Linear Control

The patented high flow offset disc allows a linear response resulting in greater central and excellent flow regulation.

Key Benefits

- PVCu butterfly valve for water applications with high performances.
- The patented disc with offset shape has the greatest flow rate on the market and minimum low pressure drops.
- The offset disc allows a linear response and excellent flow regulation.
- The EPDM main gasket is a certified component that covers the body and ensures a secure seal.
- Shaft completely isolated from fluid.
- New valve closing system with safety lock system and 19 positions for accurate regulation.
- Easy system to actuate with only two bolts to disassemble the handle.
- Actuator ready in accordance to ISO5211.
- Control options: Hand operated; Gearbox; Pneumatic or Electric actuators.



Valve Closing System

The design of the valve closing system makes it extremely easy to use, with 19 positions available between the opening and closing of the system.

For a finer readjustment of the flow rate, the opening and closing of the system can be adjusted between 0° and 90°.

When pushing the handle, the teeth that lock the valve into position are released. When the handle is released, the spring brings the handle back to the engaged position.

Valve control with four teeth engaged on the PA66 glass fiber reinforced notch plate

Lockable

Push and rotate to open and close

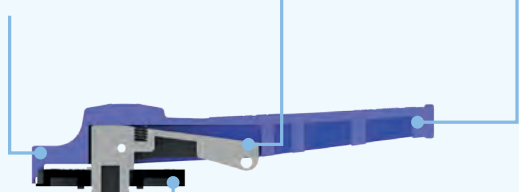

Handle support and regulation disc

Four teeth are always engaged, ensuring the locking of the valve, even in the presence of vibration caused by high flows

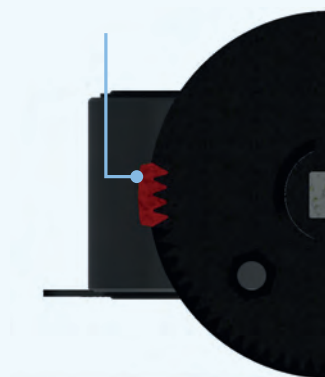

Twin scale 0°÷90°

Indicators of the degree of opening

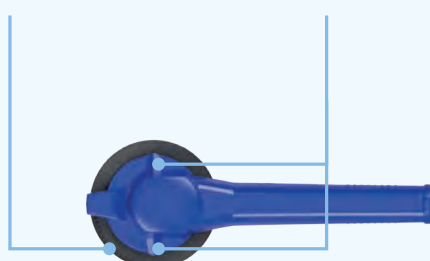

Zinc Plated Carbon steel stem with square fit according to ISO5211

Four O-Rings ensure a secure seal

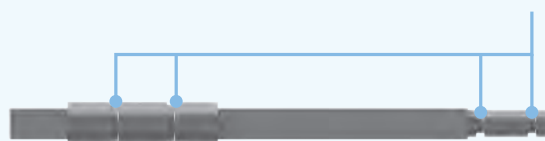

VALVE ACTUATION

DN	Q	A	H	D	ISO 5211
65	14	70	16	9	F07
80	14	70	16	9	F07
100	14	70	16	9	F07
125	17	70	19	9	F07
150	17/22	70/102	19/24	9/11	F07/F10
200	22	102	24	11	F10

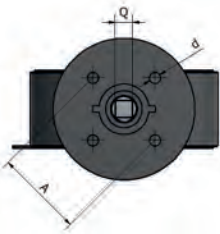

The regulating notch plate/handle can be easily removed for the mounting of an electric or pneumatic actuator, or for the fitting of a manual gearbox.

Electric Actuator



Pneumatic Actuator



Gearbox



Butterfly Valve Technical Specification

Butterfly Valve

The H series valves are manufactured incorporating a 19-position regulating plate and include electric and pneumatic actuators. They are strong, with a PVCu disc and body, zinc plated carbon steel stem and a gasket manufactured from EPDM.

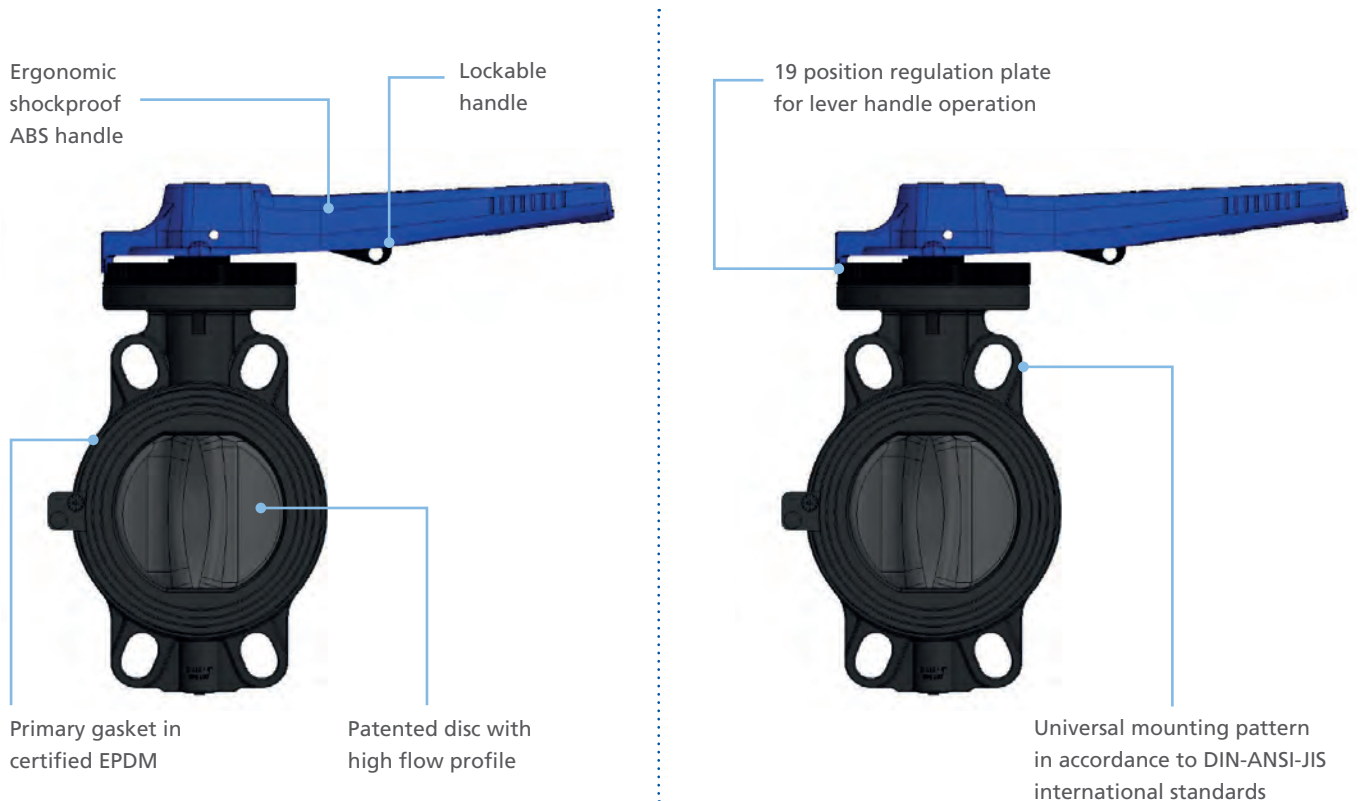

TECHNICAL SPECIFICATION	
TYPE OF VALVE	Closing or regulation flow butterfly valve with high flow disc and integrated seal
SIZE RANGE	DN60- DN80 – DN100 – DN125 – DN150 – DN200
OPERATING PRESSURE	PN 10 at 20 °C
OPERATING TEMPERATURE	0 – 60 °C
COUPLING STANDARDS	Flanging system: EN ISO 1452, EN ISO 15493, DIN 2501, EN1092-1; ASTM B16.5; JIS B2220 Actuator couplings: ISO 5211
VALVE MATERIAL	<ul style="list-style-type: none"> • Body: PVCu • Disc: PVCu • Stem: Zinc Plated carbon steel • Seals: EPDM
CONTROL OPTIONS	<ul style="list-style-type: none"> • Hand operated lever with 19 position regulating plate • Gearbox • Pneumatic actuator • Electric actuator

EFFAST Product Range for Water Application

EFFAST Pressure Systems are suited to a wide range of Commercial and Industrial applications – from shopping centres and supermarkets to hotels, factories and power generators. Each valve is available across different materials including, PVCu, ABS and PPH and are available electrically or pneumatically actuated if required.

The systems are WRAS approved for use with potable water and can be easily and permanently assembled using solvent cement, electro-fusion weld or mechanical installation.

Applications include:

- Swimming pools and spas
- Cold water systems
- Chilled water
- Agriculture
- Water treatment
- Chemical processing and industrial
- Food and beverage processing
- Boosted cold water systems

TECHNICAL SPECIFICATION		Range
	Double Union Ball Valve BV Range	From 20 mm to 110 mm; From 3/8" to 4"
	Single Union Ball Valve SV Range	From 20 mm to 110 mm; From 3/8" to 4"
	Double Union Ball Valve Socket Compression Joint BBG Range	From 20 mm to 110
	Single Union Ball Valve Socket Compression Joint SGE Range	From 20 mm to 110
	Double Union Ball Valve BX Range	From 20 mm to 110 mm; From 3/8" to 4"
	Double Union Ball Valve with HDPE Spigots BXP Range	From 20 mm to 110 mm
	Check Valve Clear Solvent Cement CVT Range	From 16 mm to 110 mm; From 3/8" to 4"

TECHNICAL SPECIFICATION		Range
	Foot Valve Double Union HV range	From 16 mm to 110 mm; From 3/8" to 4"
	Sightglass with Union IND Range	From 16 mm to 110 mm
	Swing Check Valve CKD Range	From 63 mm to 225 mm; From 2" to 8"
	Diaphragm Valve MMD Range	From 20 mm to 63 mm; From 3/8" to 2"
	Pipe and Fittings	From 16 mm to 315 mm; From 3/8" to 8"
	Glue and Solvent	Glue for large diameters THF Free and Solvent